

## Mardome Contents

**Please** unpack and check that all correct parts are included and undamaged.

All **Mardome Ultra** (Unvented or Vented)

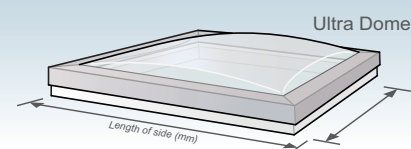

All **Mardome Ultra** (Unvented or Vented)

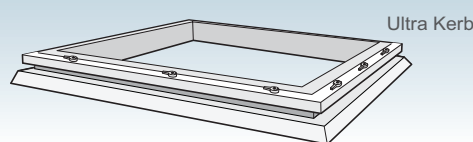

With this dome assembly, you will receive:

**Ultra Dome Latch Key**

Ultra Latch  
Key  
x2

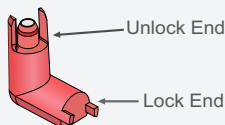

With this kerb assembly, you will receive:

**Kerb Fixing**

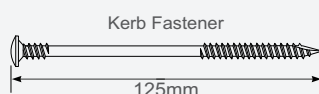

## Fixing Quantities

Length of Nominal Dome Side (mm)	Number of fixings per side
600, 750	2
900, 1050, 1200	3
1350, 1500, 1650	4
1800, 1950	5
2100, 2250	6
2400	7

(All fixings supplied in packs of 5.)

## Mardome Installation

**Please** note that all Health and Safety Regulations must be followed on site throughout the installation process.

**Ultra dome on to existing upstand**

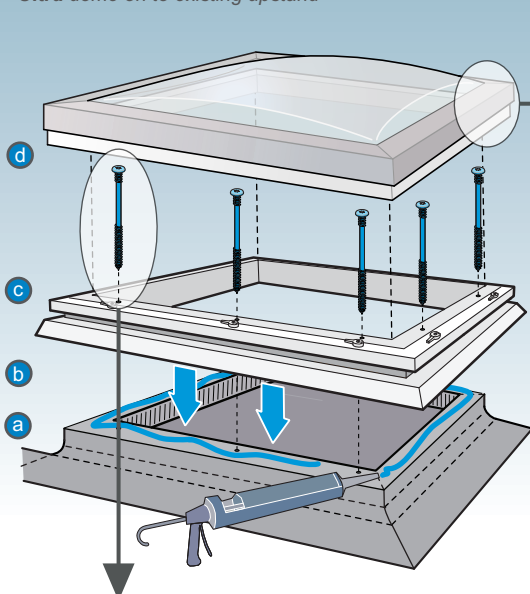

**d Ultra Latch dome alignment for existing upstand OR sloping or 300mm kerb**

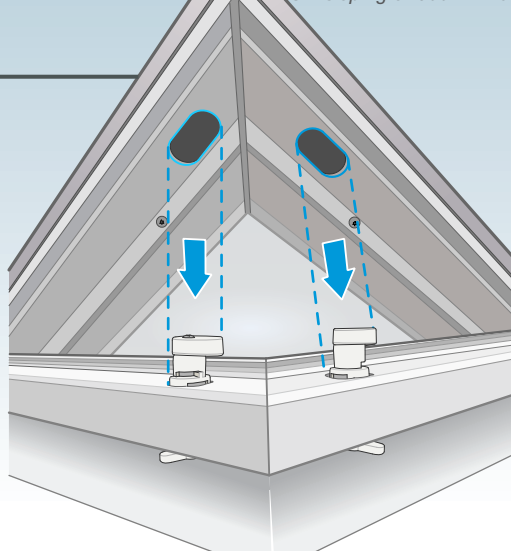

## Installation Instructions

**a** Install roof covering to cover existing upstand in accordance with manufacturer's installation recommendations.

**N.B.** It is important that there should be no excessive build up of layers, the top surface should be level and free from any protrusions or projections which may prevent adequate weather proofing.

**b** Mastic/Silicone around the edge of the upstand opening and correctly place Ultra kerb, ensuring it is located squarely to the upstand.

**c** Fix Ultra kerb to the builders upstand using the 125mm kerb fastener.

**d** Ensure each latch is in the **Start Position** (parallel to the Ultra kerb, to align with the slots in the Ultra dome frame) then carefully remove dome from its packaging, and place squarely onto Ultra kerb ensuring it locates correctly over all latches.

**e** Rotate each latch ¼ turn anti-clockwise whilst firmly pushing dome down onto kerb, until the latch clicks into its **End Position**.

Remove latch operating tab by rotating ¼ turn clockwise, and discard.

**f** IF dome removal is subsequently required:

i. Insert the **Unlock** end of the red Ultra Latch Key into the bottom of the latch (with the **Lock** end facing outwards) and push upwards until it clicks into place.  
ii. Rotate the latch ¼ turn clockwise whilst firmly pushing dome down onto kerb, until the **Lock** end is parallel to the kerb, to release. Remove key by pulling downwards.  
iii. Repeat for each latch, then lift off dome assembly.

**g** To refit the dome, insert the **Lock** end of the red Ultra Latch Key into the bottom of the latch with the **Unlock** end facing outwards.

i. Rotate the latch ¼ turn anti-clockwise whilst firmly pushing dome down onto kerb, until the latch clicks into its **End Position**.  
ii. Remove key by rotating ¼ turn clockwise.  
iii. Repeat for each latch.

## Kerb Fixing

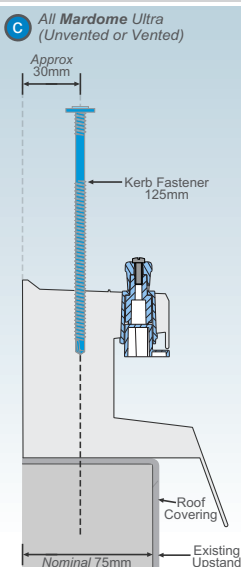

## Ultra Dome Installation

**Please** select the relevant detail for locking or unlocking dome:

**e Ultra Latch dome locking**

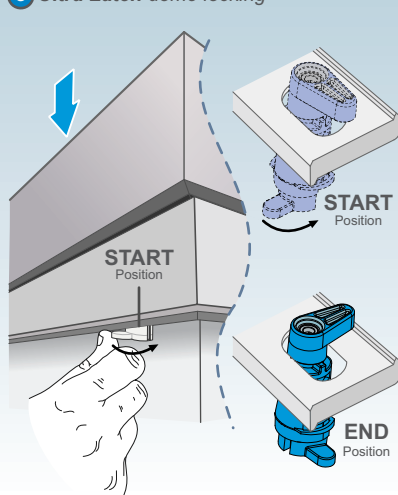

**NOTE:** Rotate latch counter-clockwise to **LOCK**.

**f Ultra Latch Further Information**  
Unlocking of dome with key

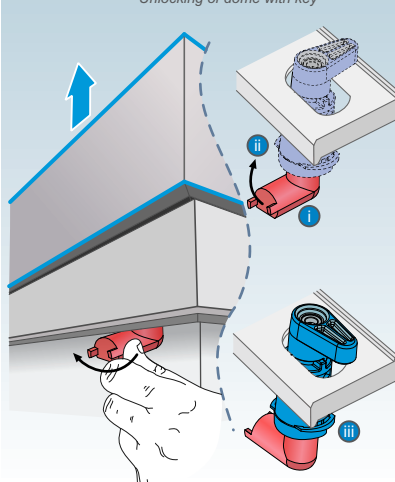

**NOTE:** Rotate key clockwise to **UNLOCK**.

**TECHNICAL SUPPORT:** For any technical information/queries please contact your supplier.

Brett Martin Daylight Systems operates a policy of continuous product improvement, and reserves the right to alter specifications at any time without notice. Every effort has been taken to ensure all details contained in this document are correct at the time of going to press but this document should be used only as a guide and does not in any way form part of a contract or warranty. It is the customer's responsibility to ensure that the product is suitable for the actual conditions of use, which are beyond the control of Brett Martin Daylight Systems.

## Mardome Contents

**Please** unpack and check that all correct parts are included and undamaged.

All **Mardome Ultra** (Unvented or Vented)

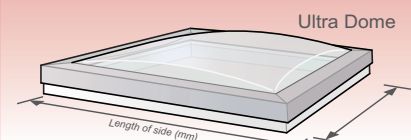

All **Mardome Ultra** (Unvented or Vented)

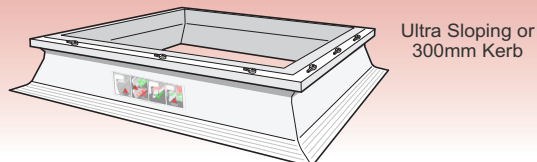

With this dome assembly, you will receive:  
**Ultra Dome Latch Key**

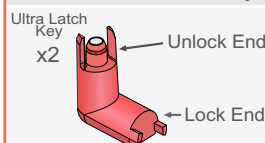

With this kerb assembly, you will receive:  
**Kerb Fixing**

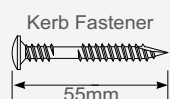

## Mardome Installation

### c Roof Covering Installation

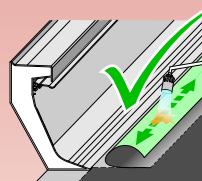

If required, lightly torch roof covering.



**WARNING:**  
Never apply direct heat or naked flame to the roof light!

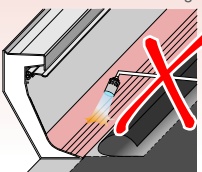

### d IMPORTANT: Roof Covering Clamp Locking



Push along line as shown to lock.  
**DO NOT** push on soft area!

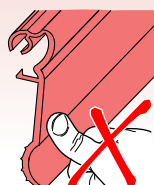

## Mardome Installation

**Please** note that all Health and Safety Regulations must be followed on site throughout the installation process.

**Ultra dome on to sloping or 300mm kerb**

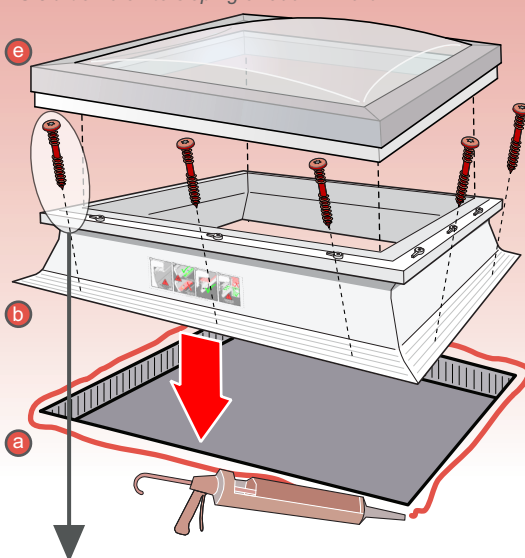

### Kerb Fixing

**b c All Mardome Ultra** (Unvented or Vented)

- Kerb
- Roof Covering
- Structural Member
- Insulation

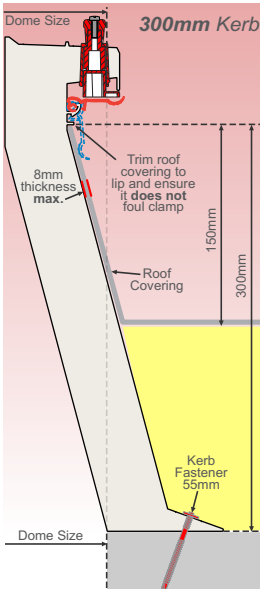
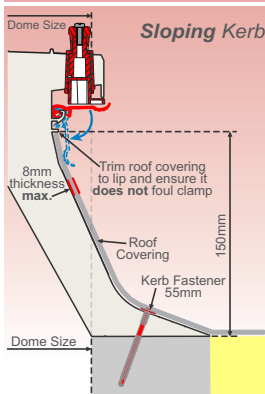

## Ultra Dome Installation

**Please** select the relevant detail for locking or unlocking dome:

### f Ultra Latch dome locking

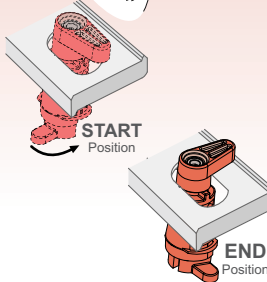
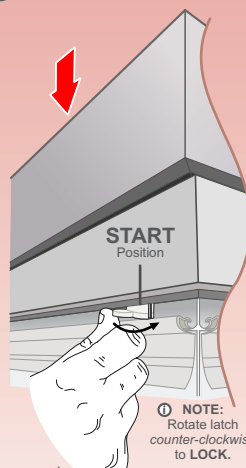

### g Ultra Latch Further Information

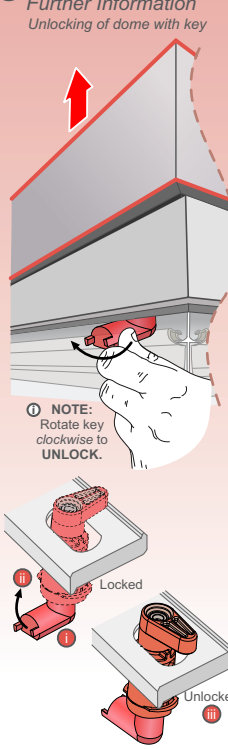

Fixing Quantities	
Length of Nominal Dome Side (mm)	Number of fixings per side
600, 750	2
900, 1050, 1200	3
1350, 1500, 1650	4
1800, 1950	5
2100, 2250	6
2400	7

(All fixings supplied in packs of 5.)

## Installation Instructions

**a** Mastic/Silicone around the edge of the roof opening and correctly position kerb, ensuring it is located squarely over the roof opening.

**b** Fix kerb to the roof using the 55mm kerb fastener.

See above **Fixing Quantities** table for the correct quantity of fasteners required for the size of the dome.

**c** Install roof covering up to lip, to stop under roof covering clamp, ensuring it **does not** foul clamp. Install in accordance with manufacturer's installation recommendations.

**d** **N.B.** Length of side refers to the nominal dome size (equivalent to inside base of kerb foot).

**e** **N.B.** Never apply direct heat or naked flame to the rooflight! Ensure the roof covering **does not** foul clamp!

**f** Lock the roof covering clamp down fully, as shown.

**g** Ensure each latch is in the **Start Position** (parallel to the Ultra kerb, to align with the slots in the Ultra dome frame) then carefully remove dome from its packaging, and place squarely onto Ultra kerb ensuring it locates correctly over all latches.

**h** Rotate each latch ¼ turn anti-clockwise whilst firmly pushing dome down onto Ultra kerb, until the latch clicks into its **End Position**.

Remove latch operating tab by rotating ¼ turn clockwise, and discard.

**i** IF dome removal is subsequently required:

- i. Insert the **Unlock** end of the red Ultra Latch Key into the bottom of the latch (with the **Lock** end facing outwards) and push upwards until it clicks into place.
- ii. Rotate the latch ¼ turn clockwise whilst firmly pushing dome down onto kerb, until the **Lock** end is parallel to the kerb, to release. Remove key by pulling downwards.
- iii. Repeat for each latch, then lift off dome assembly.

**j** To refit the dome, insert the **Lock** end of the red Ultra Latch Key into the bottom of the latch (with the **Unlock** end facing outwards).

**k** Rotate the latch ¼ turn anti-clockwise whilst firmly pushing dome down onto kerb, until the latch clicks into its **End Position**.

- i. Remove key by rotating ¼ turn clockwise.
- ii. Repeat for each latch.

**TECHNICAL SUPPORT:** For any technical information/queries please contact your supplier.

Brett Martin Daylight Systems operates a policy of continuous product improvement, and reserves the right to alter specifications at any time without notice. Every effort has been taken to ensure all details contained in this document are correct at the time of going to press but this document should be used only as a guide and does not in any way form part of a contract or warranty. It is the customer's responsibility to ensure that the product is suitable for the actual conditions of use, which are beyond the control of Brett Martin Daylight Systems.